

2296+00

2297+00

2298+00

2299+00

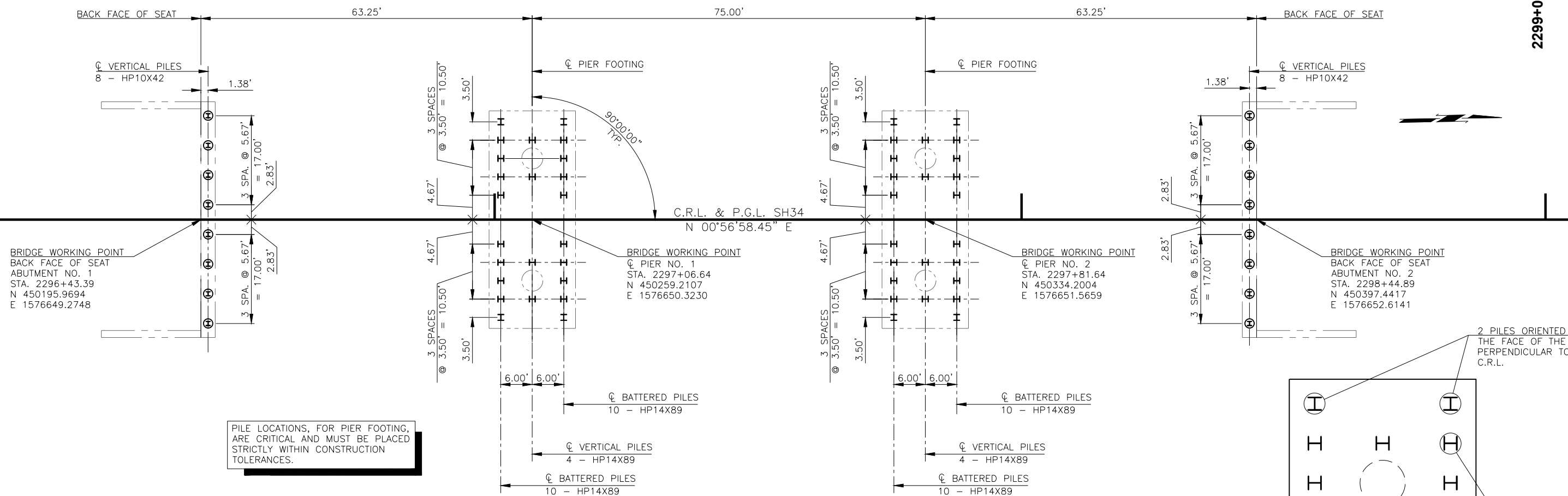

PILE LOCATIONS, FOR PIER FOOTING, ARE CRITICAL AND MUST BE PLACED STRICTLY WITHIN CONSTRUCTION TOLERANCES.

ABUTMENT SEAT PILES SHALL BE ORIENTED SUCH THAT THE FACE OF THE WEB IS PERPENDICULAR TO THE BACK FACE OF SEAT.

SUBSTRUCTURE LAYOUT
1" = 10'

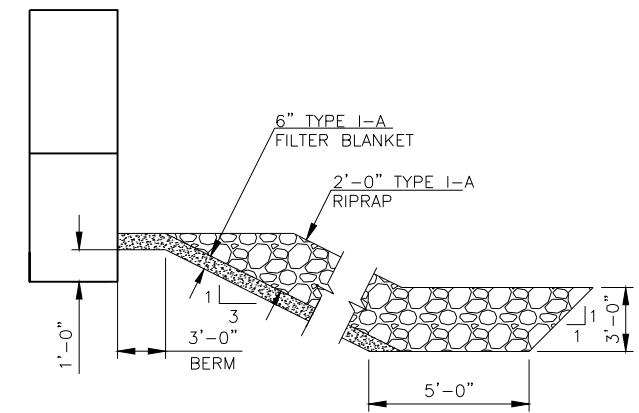

RIPRAP AND FILTER BLANKET DETAIL
(DIMENSIONS AND SLOPE PERPENDICULAR TO FACE OF ABUTMENT)

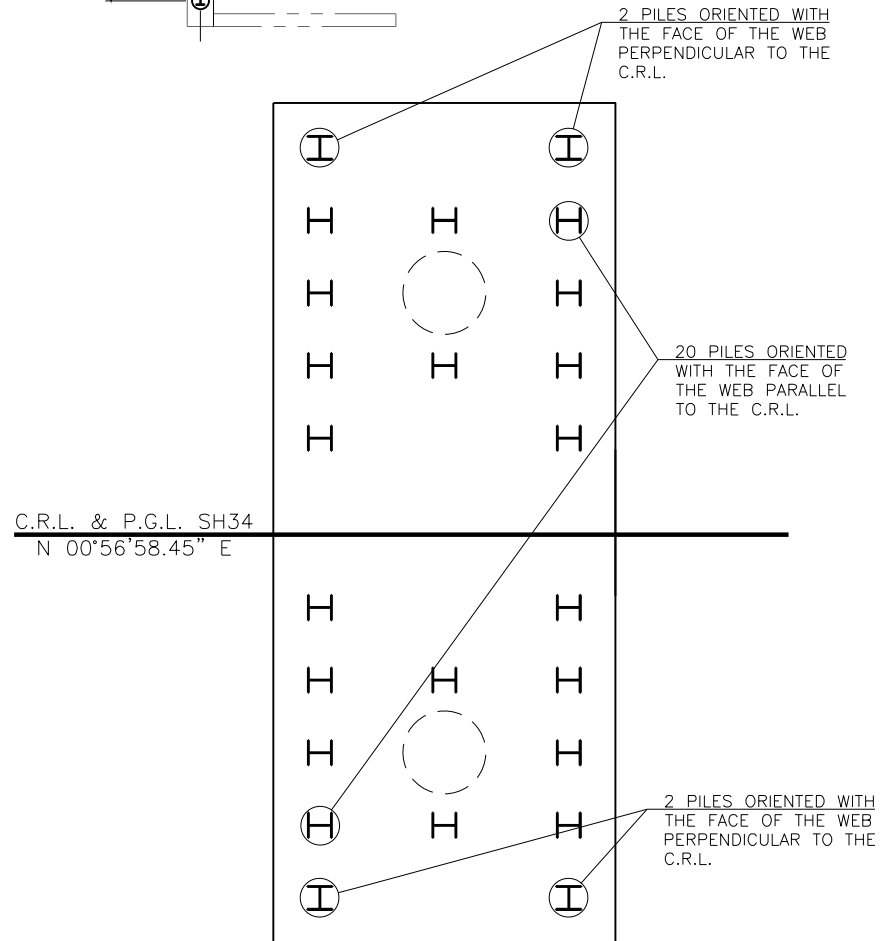

PIER FOOTING PILE ORIENTATION

DESIGN	J.W.H.	SH34 OVER S. PERSIMMON CREEK	WOODWARD COUNTY
DRAWN	Z.M.B.	BRIDGE A	
CHECKED	J.W.H.	SUBSTRUCTURE LAYOUT	
APPROV.	T.A.C.		
SQUAD	CEC		
		JOB PIECE NO. 28825(04)	SHEET NO. 24

